

172-271

06-40-67

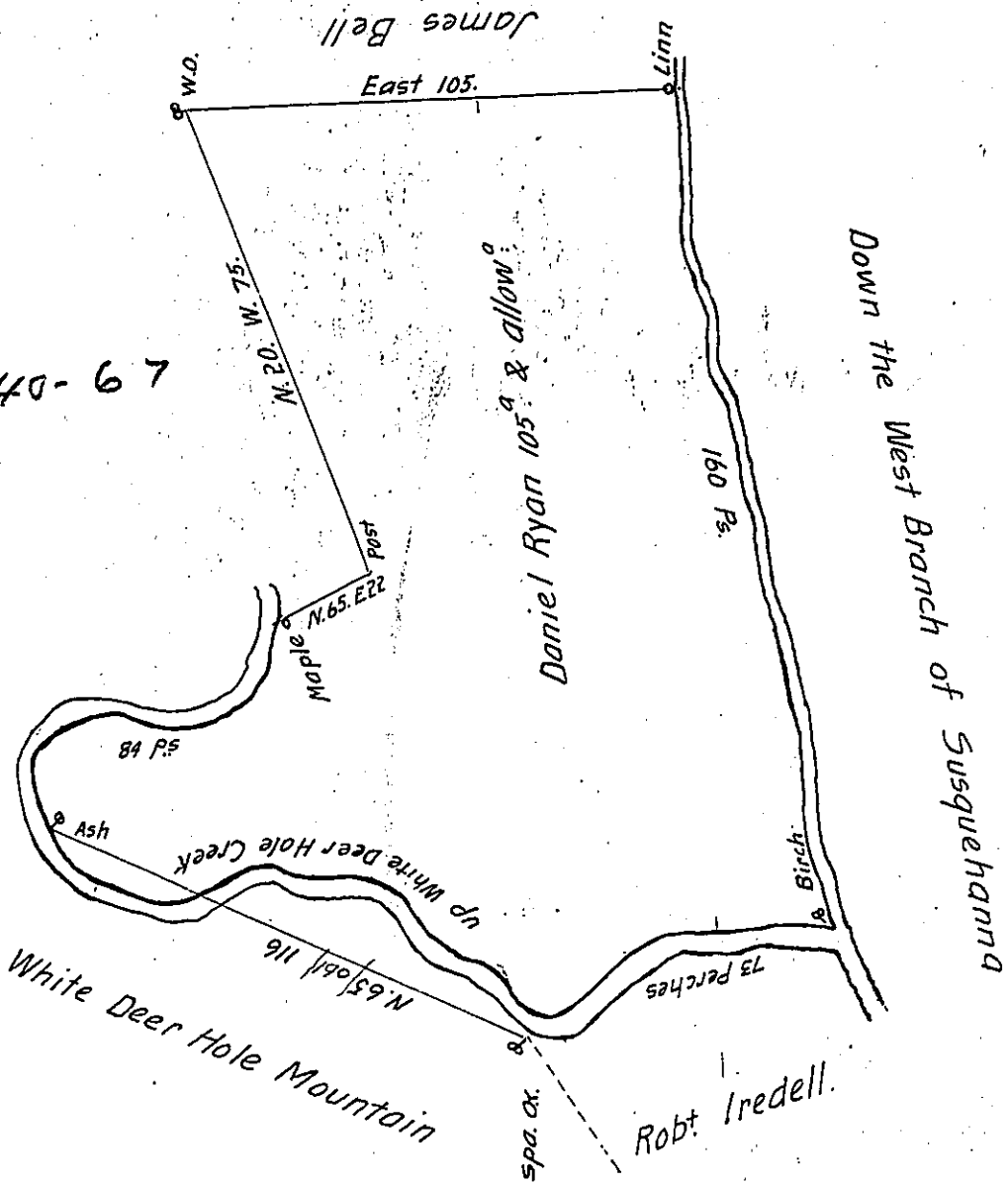

A Draught of a Tract of Land Called "Polly's Retreat" Situate on the South side of the West branch of Susquehanna, late part of the County of Berks, now Northumberland, Surveyed the 27th day of June 1769. In Pursuance of an application N^o 788 dated the 3^d day of April 1769. Containing One hundred and five acres and allowance of Six acres P. Cent for Roads &c.^a —

To P. Cha^s Lukens D.S.
John Lukens Esq^r Survey^r Gen^l.

IN TESTIMONY that the above is a copy of the original remaining on file in the Department of Internal Affairs of Pennsylvania, made conformably to an Act of Assembly approved the 16th day of February, 1833, I have hereunto set my Hand and caused the Seal of said Department to be affixed at Harrisburg, this twenty-first day of April 1904.

Grace N. Brown
Secretary of Internal Affairs.